

TURTLE NEST PROTECTORS



Exit holes for hatchlings

Hardware cloth to keep predators out but sun and rain in

Spike to anchor the box

WHY PROTECT TURTLE NESTS?

Turtle nests are regularly destroyed by predators like raccoons, otters, foxes, and crows. In fact, **less than 1% of eggs survive to maturity**. As a result, turtle nests near humans need your help and protection! By installing a nest protector, you can help more eggs survive!



HOW TO BUILD A NEST PROTECTOR

To **build a nest protector** you need one untreated 8 foot 2x4 cut into two 24" lengths and two 21" lengths. You will also need galvanized hardware cloth (wire mesh, 19 gauge) with 1/2 inch squares, stainless steel staples or wood screws with washers, eight 3 inch deck screws, and four 12 inch galvanized spikes with washers, in addition to your tools.

1 The very **first thing** you need to do is cut notches (semicircular or rectangular) in the centre of one of the 24" and one of the 21" wood lengths: these are the exit holes for the turtle hatchlings.



2 Next create a frame that is 24" by 24" using your wood lengths.

3 Cut then attach the hardware cloth to the frame using staples or screws and washers, ensure the exit notches are on the opposite side.

4 You now have a nest protector.

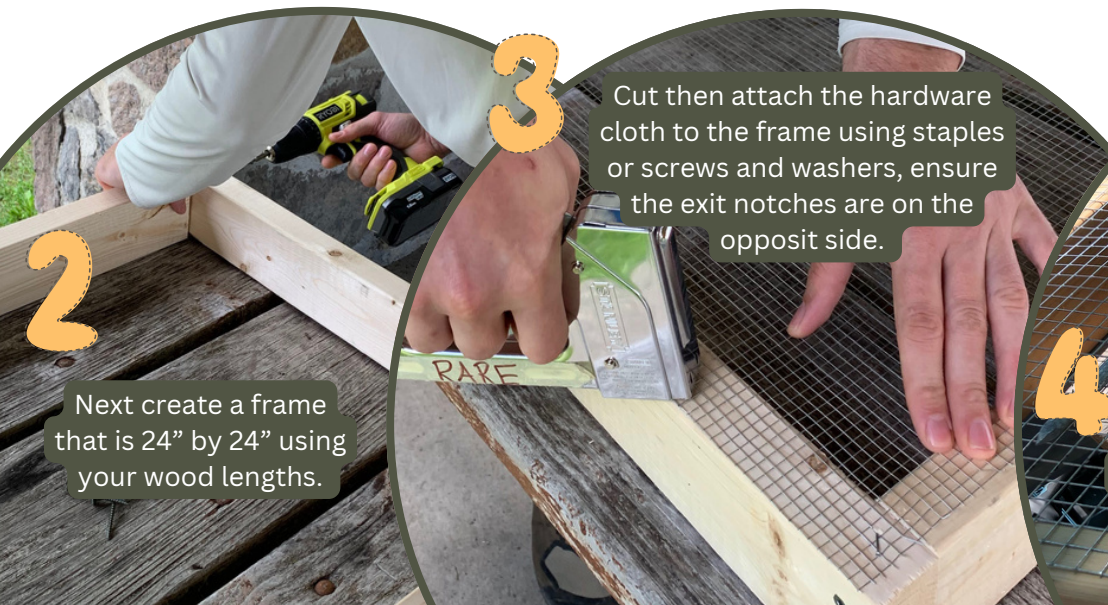



Stay at least 5 m from any nesting turtle

A completed nest will be covered with sediment

the nest is under the body of the turtle

HOW TO INSTALL A NEST PROTECTOR

Turtle nests are well hidden, thus you will only be able to protect turtle nests you actively see being laid. While the mother turtle is nesting keep your distance (more than 5 m) and wait until she has left. A successful nest will look like the turtle was never there as the mother will return all the sand and gravel back into the hole. If there is still a hole then the nest was abandoned and no eggs were laid.

First, **centre the nest under the nest protector**. Hammer one metal spike into each corner. Never cover the wire mesh as the nests needs rain and sun to incubate. Ensure all exit holes are clear. Once installed, **leave the nest protector in place until the hatchlings emerge** - this could be in the autumn (August - October) or the following spring (~May).

NEVER DIG IN OR DISTURB A TURTLE NEST AS IT IS ILLEGAL AND YOU COULD HARM THE HATCHLINGS

IMPORTANT FACTS

- Incubation takes 60-90 days then turtles will hatch
- Turtles do not emerge from the nest immediately after hatching
- Painted and Map hatchlings may stay in the nest over winter and emerge the following spring



Learn more on our website

www.turtleskingston.com

- A female turtle may take an hour to complete nesting
- Predation can occur at any point during incubation
- Nests on road shoulders cannot be protected
- Protecting nests on public property requires permission from the land owner (e.g.township/municipality)

YOU MUST HAVE PERMISSION FROM THE PROPERTY OWNER TO INSTALL A NEST PROTECTOR